

FILLMORE CORPORATION IS DEDICATED TO PROVIDING TOP NOTCH LIVING ACCOMMODATIONS. OUR BRAND NEW SUITES AT FILLMORE VILLAGE IN WABASCA ALBERTA ARE A TESTAMENT TO THAT DEDICATION. FILLMORE VILLAGE INCLUDES ONE, TWO AND THREE BEDROOM APARTMENTS. WHETHER FILLMORE VILLAGE IS YOUR FIRST OR SECOND RESIDENCE YOU CANNOT HELP BUT FEEL AT HOME. ALL SUITES INCLUDE A FULL KITCHEN INCLUDING APPLIANCES AND A SPACIOUS LIVING ROOM WITH PLENTY OF NATURAL LIGHT. ALL SUITES INCLUDE HD SMART TV IN THE LIVING ROOM AND EVERY BEDROOM AND COMPLIMENTARY WIFI INTERNET ACCESS. FOR EASE OF MIND ALL UTILITIES INCLUDING POWER, GAS, WATER, CABLE AND INTERNET ARE INCLUDED IN MONTHLY RENT.

OUR MONTHLY RATES ARE HIGHLY COMPETITIVE FOR THE NICEST LIVING ACCOMMODATIONS IN WABASCA. THERE IS NO POINT PAYING HUNDREDS OF DOLLARS PER NIGHT PER PERSON TO STAY IN THE CAMPS AND HOTELS WHEN LUXURY LIVING ACCOMMODATIONS ARE THIS EASILY AVAILABLE FOR LESS COST. MAKE COMFORTABLE LIVING IN WABASCA A REALITY.

GIVE US A CALL!

FOR ALL RENTAL INQUIRES PLEASE CONTACT:

CHRIS FILLMORE

TELEPHONE: (780) 235 - 6014

EMAIL: INFO@FILLMOREWABASCAVILLAGE.COM

WWW.FILLMOREWABASCAVILLAGE.COM



FILLMORE VILLAGE

150 - 1 STREET, WABASCA, ALBERTA



ONE BEDROOM

- 632 SQUARE FEET
- FULL KITCHEN WITH HIGH QUALITY APPLIANCES
- HIGH SPEED WIFI
- HD SMART TV IN LIVING ROOM AND BEDROOM
- LARGE BEDROOM
- FULL BATH
- STORAGE ROOM W/ IN-SUITE LAUNDRY
- ONE ENERGIZED PARKING STALL INCL.
- LARGE DECK WITH A VIEW

MONTHLY RATE OF \$ 2, 000

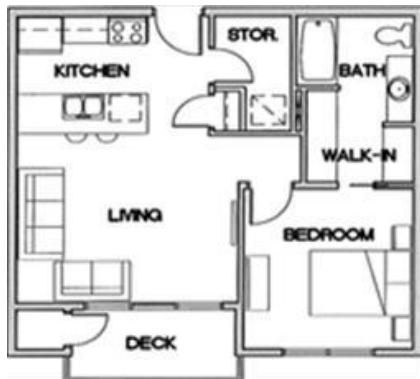

TWO BEDROOM

- 940 SQUARE FEET
- FULL KITCHEN WITH HIGH QUALITY APPLIANCES
- HIGH SPEED WIFI
- HD SMART TV IN LIVING ROOM AND BEDROOM
- 2 LARGE BEDROOMS WITH TV
- 2 FULL BATHS
- STORAGE ROOM W/ IN-SUITE LAUNDRY
- TWO ENERGIZED PARKING STALL INCL.
- LARGE DECK WITH A VIEW

MONTHLY RATE OF \$,750.00



THREE BEDROOM

- 1236 SQUARE FEET
- FULL KITCHEN WITH HIGH QUALITY APPLIANCES
- HIGH SPEED WIFI
- HD SMART TV IN LIVING ROOM AND BEDROOM
- 3 LARGE BEDROOMS WITH TV
- 2 FULL BATHS
- STORAGE ROOM W/ IN-SUITE LAUNDRY
- TWO ENERGIZED PARKING STALL INCL.
- LARGE DECK WITH A VIEW

MONTHLY RATE OF \$,250.00

